



## ANALYTICAL REPORT

Lab Number:	L1903979
Client:	George Weymouth 6 Agawam Circle Billerica, MA 01821
ATTN:	George Weymouth
Phone:	(978) 663-9234
Project Name:	MILDRED STRANG
Project Number:	Not Specified
Report Date:	05/06/19

The original project report/data package is held by Alpha Analytical. This report/data package is paginated and should be reproduced only in its entirety. Alpha Analytical holds no responsibility for results and/or data that are not consistent with the original.

Certifications & Approvals: MA (M-MA086), NH NELAP (2064), CT (PH-0574), IL (200077), ME (MA00086), MD (348), NJ (MA935), NY (11148), NC (25700/666), PA (68-03671), RI (LAO00065), TX (T104704476), VT (VT-0935), VA (460195), USDA (Permit #P330-17-00196).

---

Eight Walkup Drive, Westborough, MA 01581-1019  
508-898-9220 (Fax) 508-898-9193 800-624-9220 - [www.alphalab.com](http://www.alphalab.com)



**Project Name:** MILDRED STRANG  
**Project Number:** Not Specified

**Lab Number:** L1903979  
**Report Date:** 05/06/19

<b>Alpha Sample ID</b>	<b>Client ID</b>	<b>Matrix</b>	<b>Sample Location</b>	<b>Collection Date/Time</b>	<b>Receive Date</b>
L1903979-01	001 EAST	SOIL	YORKTOWN, NY	12/29/18 12:30	01/31/19
L1903979-02	002 EAST	SOLID	YORKTOWN, NY	12/29/18 12:35	01/31/19

**Project Name:** MILDRED STRANG  
**Project Number:** Not Specified

**Lab Number:** L1903979  
**Report Date:** 05/06/19

### Case Narrative

The samples were received in accordance with the Chain of Custody and no significant deviations were encountered during the preparation or analysis unless otherwise noted. Sample Receipt, Container Information, and the Chain of Custody are located at the back of the report.

Results contained within this report relate only to the samples submitted under this Alpha Lab Number and meet NELAP requirements for all NELAP accredited parameters unless otherwise noted in the following narrative. The data presented in this report is organized by parameter (i.e. VOC, SVOC, etc.). Sample specific Quality Control data (i.e. Surrogate Spike Recovery) is reported at the end of the target analyte list for each individual sample, followed by the Laboratory Batch Quality Control at the end of each parameter. Tentatively Identified Compounds (TICs), if requested, are reported for compounds identified to be present and are not part of the method/program Target Compound List, even if only a subset of the TCL are being reported. If a sample was re-analyzed or re-extracted due to a required quality control corrective action and if both sets of data are reported, the Laboratory ID of the re-analysis or re-extraction is designated with an "R" or "RE", respectively.

When multiple Batch Quality Control elements are reported (e.g. more than one LCS), the associated samples for each element are noted in the grey shaded header line of each data table. Any Laboratory Batch, Sample Specific % recovery or RPD value that is outside the listed Acceptance Criteria is bolded in the report. In reference to questions H (CAM) or 4 (RCP) when "NO" is checked, the performance criteria for CAM and RCP methods allow for some quality control failures to occur and still be within method compliance. In these instances, the specific failure is not narrated but noted in the associated QC Outlier Summary Report, located directly after the Case Narrative. QC information is also incorporated in the Data Usability Assessment table (Format 11) of our Data Merger tool, where it can be reviewed in conjunction with the sample result, associated regulatory criteria and any associated data usability implications.

Soil/sediments, solids and tissues are reported on a dry weight basis unless otherwise noted. Definitions of all data qualifiers and acronyms used in this report are provided in the Glossary located at the back of the report.

**HOLD POLICY** - For samples submitted on hold, Alpha's policy is to hold samples (with the exception of Air canisters) free of charge for 21 calendar days from the date the project is completed. After 21 calendar days, we will dispose of all samples submitted including those put on hold unless you have contacted your Alpha Project Manager and made arrangements for Alpha to continue to hold the samples. Air canisters will be disposed after 3 business days from the date the project is completed.

Please contact Project Management at 800-624-9220 with any questions.

---

**Project Name:** MILDRED STRANG  
**Project Number:** Not Specified

**Lab Number:** L1903979  
**Report Date:** 05/06/19

### Case Narrative (continued)

#### Report Revision

May 06, 2019: The collection dates have been amended.

#### Report Submission

All non-detect (ND) or estimated concentrations (J-qualified) have been quantitated to the limit noted in the MDL column.

#### Sample Receipt

L1903979-01 and -02: The sample was received in an inappropriate container for the PCB analysis.

L1903979-01 and -02: The PCB analysis was received with the method required holding time exceeded and was performed with the client's authorization.

The samples were received at the laboratory above the required temperature range and were not on ice.

#### PCBs

L1903979-01 and -02: The surrogate recoveries are below the acceptance criteria for 2,4,5,6-tetrachloro-m-xylene (0%) and decachlorobiphenyl (0%) due to the dilution required to quantitate the sample. Re-extraction was not required; therefore, the results of the original analysis are reported.

I, the undersigned, attest under the pains and penalties of perjury that, to the best of my knowledge and belief and based upon my personal inquiry of those responsible for providing the information contained in this analytical report, such information is accurate and complete. This certificate of analysis is not complete unless this page accompanies any and all pages of this report.

Authorized Signature:

 Melissa Cripps

Title: Technical Director/Representative

Date: 05/06/19

# ORGANICS

# PCBS

**Project Name:** MILDRED STRANG**Lab Number:** L1903979**Project Number:** Not Specified**Report Date:** 05/06/19**SAMPLE RESULTS**

Lab ID: L1903979-01 D

Date Collected: 12/29/18 12:30

Client ID: 001 EAST

Date Received: 01/31/19

Sample Location: YORKTOWN, NY

Field Prep: Not Specified

Sample Depth:

Matrix: Soil

Extraction Method: EPA 3546

Analytical Method: 1,8082A

Extraction Date: 02/02/19 08:55

Analytical Date: 02/07/19 09:12

Cleanup Method: EPA 3665A

Analyst: WR

Cleanup Date: 02/02/19

Percent Solids: 74%

Cleanup Method: EPA 3660B

Cleanup Date: 02/03/19

Parameter	Result	Qualifier	Units	RL	MDL	Dilution Factor	Column
Polychlorinated Biphenyls by GC - Westborough Lab							
Aroclor 1016	ND		ug/kg	2240	199.	50	A
Aroclor 1221	ND		ug/kg	2240	224.	50	A
Aroclor 1232	ND		ug/kg	2240	475.	50	A
Aroclor 1242	ND		ug/kg	2240	302.	50	A
Aroclor 1248	ND		ug/kg	2240	336.	50	A
Aroclor 1254	ND		ug/kg	2240	245.	50	A
Aroclor 1260	13300		ug/kg	2240	414.	50	B
Aroclor 1262	ND		ug/kg	2240	284.	50	A
Aroclor 1268	ND		ug/kg	2240	232.	50	A
PCBs, Total	13300		ug/kg	2240	199.	50	B

Surrogate	% Recovery	Qualifier	Acceptance Criteria	Column
2,4,5,6-Tetrachloro-m-xylene	0	Q	30-150	A
Decachlorobiphenyl	0	Q	30-150	A
2,4,5,6-Tetrachloro-m-xylene	0	Q	30-150	B
Decachlorobiphenyl	0	Q	30-150	B

**Project Name:** MILDRED STRANG**Lab Number:** L1903979**Project Number:** Not Specified**Report Date:** 05/06/19**SAMPLE RESULTS**

Lab ID: L1903979-02 D

Date Collected: 12/29/18 12:35

Client ID: 002 EAST

Date Received: 01/31/19

Sample Location: YORKTOWN, NY

Field Prep: Not Specified

Sample Depth:

Matrix: Solid

Extraction Method: EPA 3540C

Analytical Method: 1,8082A

Extraction Date: 02/05/19 10:45

Analytical Date: 02/07/19 11:59

Cleanup Method: EPA 3630

Analyst: WR

Cleanup Date: 02/06/19

Percent Solids: Results reported on an 'AS RECEIVED' basis.

Cleanup Method: EPA 3665A

Cleanup Date: 02/06/19

Cleanup Method: EPA 3660B

Cleanup Date: 02/06/19

Parameter	Result	Qualifier	Units	RL	MDL	Dilution Factor	Column
Polychlorinated Biphenyls by GC - Westborough Lab							
Aroclor 1016	ND		ug/kg	1510000	428000	2500	A
Aroclor 1221	ND		ug/kg	1510000	440000	2500	A
Aroclor 1232	ND		ug/kg	1510000	335000	2500	A
Aroclor 1242	ND		ug/kg	753000	270000	2500	A
Aroclor 1248	ND		ug/kg	1510000	422000	2500	A
Aroclor 1254	ND		ug/kg	1510000	307000	2500	A
Aroclor 1260	24000000		ug/kg	1510000	338000	2500	B
Aroclor 1262	ND		ug/kg	1510000	310000	2500	A
Aroclor 1268	ND		ug/kg	753000	266000	2500	A
PCBs, Total	24000000		ug/kg	753000	266000	2500	B

Surrogate	% Recovery	Qualifier	Acceptance Criteria	Column
2,4,5,6-Tetrachloro-m-xylene	0	Q	30-150	A
Decachlorobiphenyl	0	Q	30-150	A
2,4,5,6-Tetrachloro-m-xylene	0	Q	30-150	B
Decachlorobiphenyl	0	Q	30-150	B



**Project Name:** MILDRED STRANG  
**Project Number:** Not Specified

**Lab Number:** L1903979  
**Report Date:** 05/06/19

**Method Blank Analysis**  
**Batch Quality Control**

**Analytical Method:** 1,8082A  
**Analytical Date:** 02/06/19 21:18  
**Analyst:** WR

**Extraction Method:** EPA 3546  
**Extraction Date:** 02/02/19 08:55  
**Cleanup Method:** EPA 3665A  
**Cleanup Date:** 02/02/19  
**Cleanup Method:** EPA 3660B  
**Cleanup Date:** 02/03/19

Parameter	Result	Qualifier	Units	RL	MDL	Column
Polychlorinated Biphenyls by GC - Westborough Lab for sample(s): 01 Batch: WG1203279-1						
Aroclor 1016	ND		ug/kg	32.0	2.84	A
Aroclor 1221	ND		ug/kg	32.0	3.21	A
Aroclor 1232	ND		ug/kg	32.0	6.79	A
Aroclor 1242	ND		ug/kg	32.0	4.32	A
Aroclor 1248	ND		ug/kg	32.0	4.80	A
Aroclor 1254	ND		ug/kg	32.0	3.50	A
Aroclor 1260	ND		ug/kg	32.0	5.92	A
Aroclor 1262	ND		ug/kg	32.0	4.07	A
Aroclor 1268	ND		ug/kg	32.0	3.32	A
PCBs, Total	ND		ug/kg	32.0	2.84	A

Surrogate	%Recovery	Qualifier	Acceptance Criteria	Column
2,4,5,6-Tetrachloro-m-xylene	56		30-150	A
Decachlorobiphenyl	50		30-150	A
2,4,5,6-Tetrachloro-m-xylene	62		30-150	B
Decachlorobiphenyl	61		30-150	B

**Project Name:** MILDRED STRANG  
**Project Number:** Not Specified

**Lab Number:** L1903979  
**Report Date:** 05/06/19

**Method Blank Analysis**  
**Batch Quality Control**

**Analytical Method:** 1,8082A  
**Analytical Date:** 02/06/19 10:48  
**Analyst:** WR

**Extraction Method:** EPA 3540C  
**Extraction Date:** 02/04/19 19:50  
**Cleanup Method:** EPA 3630  
**Cleanup Date:** 02/05/19  
**Cleanup Method:** EPA 3665A  
**Cleanup Date:** 02/06/19  
**Cleanup Method:** EPA 3660B  
**Cleanup Date:** 02/06/19

Parameter	Result	Qualifier	Units	RL	MDL	Column
Polychlorinated Biphenyls by GC - Westborough Lab for sample(s): 02 Batch: WG1203695-1						
Aroclor 1016	ND		ug/kg	539	153.	A
Aroclor 1221	ND		ug/kg	539	158.	A
Aroclor 1232	ND		ug/kg	539	120.	A
Aroclor 1242	ND		ug/kg	270	96.5	A
Aroclor 1248	ND		ug/kg	539	151.	A
Aroclor 1254	ND		ug/kg	539	110.	A
Aroclor 1260	ND		ug/kg	539	121.	A
Aroclor 1262	ND		ug/kg	539	111.	A
Aroclor 1268	ND		ug/kg	270	95.1	A
PCBs, Total	ND		ug/kg	270	95.1	A

Surrogate	%Recovery	Qualifier	Acceptance Criteria	Column
2,4,5,6-Tetrachloro-m-xylene	79		30-150	A
Decachlorobiphenyl	67		30-150	A
2,4,5,6-Tetrachloro-m-xylene	86		30-150	B
Decachlorobiphenyl	84		30-150	B

**Lab Control Sample Analysis****Batch Quality Control****Project Name:** MILDRED STRANG**Lab Number:** L1903979**Project Number:** Not Specified**Report Date:** 05/06/19

<b>Parameter</b>	<b>LCS %Recovery</b>	<b>Qual</b>	<b>LCSD %Recovery</b>	<b>Qual</b>	<b>%Recovery Limits</b>	<b>RPD</b>	<b>Qual</b>	<b>RPD Limits</b>	<b>Column</b>
Polychlorinated Biphenyls by GC - Westborough Lab Associated sample(s): 01 Batch: WG1203279-2 WG1203279-3									
Aroclor 1016	65		63		40-140	3		50	A
Aroclor 1260	59		59		40-140	0		50	A

<b>Surrogate</b>	<b>LCS %Recovery</b>	<b>Qual</b>	<b>LCSD %Recovery</b>	<b>Qual</b>	<b>Acceptance Criteria</b>	<b>Column</b>
2,4,5,6-Tetrachloro-m-xylene	57		56		30-150	A
Decachlorobiphenyl	53		52		30-150	A
2,4,5,6-Tetrachloro-m-xylene	61		61		30-150	B
Decachlorobiphenyl	63		65		30-150	B

**Lab Control Sample Analysis****Batch Quality Control****Project Name:** MILDRED STRANG**Lab Number:** L1903979**Project Number:** Not Specified**Report Date:** 05/06/19

<b>Parameter</b>	<b>LCS %Recovery</b>	<b>Qual</b>	<b>LCSD %Recovery</b>	<b>Qual</b>	<b>%Recovery Limits</b>	<b>RPD</b>	<b>Qual</b>	<b>RPD Limits</b>	<b>Column</b>
Polychlorinated Biphenyls by GC - Westborough Lab Associated sample(s): 02 Batch: WG1203695-2 WG1203695-3									
Aroclor 1016	60		52		40-140	14		50	A
Aroclor 1260	48		44		40-140	9		50	A

<b>Surrogate</b>	<b>LCS %Recovery</b>	<b>Qual</b>	<b>LCSD %Recovery</b>	<b>Qual</b>	<b>Acceptance Criteria</b>	<b>Column</b>
2,4,5,6-Tetrachloro-m-xylene	79		66		30-150	A
Decachlorobiphenyl	65		57		30-150	A
2,4,5,6-Tetrachloro-m-xylene	83		71		30-150	B
Decachlorobiphenyl	80		68		30-150	B

# **INORGANICS & MISCELLANEOUS**

**Project Name:** MILDRED STRANG**Project Number:** Not Specified**Lab Number:** L1903979**Report Date:** 05/06/19**SAMPLE RESULTS****Lab ID:** L1903979-01**Client ID:** 001 EAST**Sample Location:** YORKTOWN, NY**Date Collected:** 12/29/18 12:30**Date Received:** 01/31/19**Field Prep:** Not Specified**Sample Depth:****Matrix:** Soil

Parameter	Result	Qualifier	Units	RL	MDL	Dilution Factor	Date Prepared	Date Analyzed	Analytical Method	Analyst
General Chemistry - Westborough Lab										
Solids, Total	73.6		%	0.100	NA	1	-	02/01/19 12:37	121,2540G	RI



**Lab Duplicate Analysis**  
*Batch Quality Control***Project Name:** MILDRED STRANG**Project Number:** Not Specified**Lab Number:** L1903979**Report Date:** 05/06/19

Parameter	Native Sample	Duplicate Sample	Units	RPD	Qual	RPD Limits
General Chemistry - Westborough Lab Associated sample(s): 01 QC Batch ID: WG1203091-1 QC Sample: L1903976-02 Client ID: DUP Sample						
Solids, Total	86.2	87.0	%	1		20

**Project Name:** MILDRED STRANG**Lab Number:** L1903979**Project Number:** Not Specified**Report Date:** 05/06/19**Sample Receipt and Container Information**

Were project specific reporting limits specified?

YES

**Cooler Information****Cooler**                      **Custody Seal**

A                                  Absent

**Container Information**

<b>Container ID</b>	<b>Container Type</b>	<b>Cooler</b>	<b>Initial pH</b>	<b>Final pH</b>	<b>Temp deg C</b>	<b>Pres</b>	<b>Seal</b>	<b>Frozen Date/Time</b>	<b>Analysis(*)</b>
L1903979-01A	Other container unpreserved	A	NA		13.1	Y	Absent		TS(7),NYTCL-8082(14)
L1903979-02A	Bag	A	NA		13.1	Y	Absent		NYTCL-8082-CAULK(14)



**Project Name:** MILDRED STRANG**Lab Number:** L1903979**Project Number:** Not Specified**Report Date:** 05/06/19

## GLOSSARY

### Acronyms

DL	- Detection Limit: This value represents the level to which target analyte concentrations are reported as estimated values, when those target analyte concentrations are quantified below the limit of quantitation (LOQ). The DL includes any adjustments from dilutions, concentrations or moisture content, where applicable. (DoD report formats only.)
EDL	- Estimated Detection Limit: This value represents the level to which target analyte concentrations are reported as estimated values, when those target analyte concentrations are quantified below the reporting limit (RL). The EDL includes any adjustments from dilutions, concentrations or moisture content, where applicable. The use of EDLs is specific to the analysis of PAHs using Solid-Phase Microextraction (SPME).
EMPC	- Estimated Maximum Possible Concentration: The concentration that results from the signal present at the retention time of an analyte when the ions meet all of the identification criteria except the ion abundance ratio criteria. An EMPC is a worst-case estimate of the concentration.
EPA	- Environmental Protection Agency.
LCS	- Laboratory Control Sample: A sample matrix, free from the analytes of interest, spiked with verified known amounts of analytes or a material containing known and verified amounts of analytes.
LCSD	- Laboratory Control Sample Duplicate: Refer to LCS.
LFB	- Laboratory Fortified Blank: A sample matrix, free from the analytes of interest, spiked with verified known amounts of analytes or a material containing known and verified amounts of analytes.
LOD	- Limit of Detection: This value represents the level to which a target analyte can reliably be detected for a specific analyte in a specific matrix by a specific method. The LOD includes any adjustments from dilutions, concentrations or moisture content, where applicable. (DoD report formats only.)
LOQ	- Limit of Quantitation: The value at which an instrument can accurately measure an analyte at a specific concentration. The LOQ includes any adjustments from dilutions, concentrations or moisture content, where applicable. (DoD report formats only.)
	Limit of Quantitation: The value at which an instrument can accurately measure an analyte at a specific concentration. The LOQ includes any adjustments from dilutions, concentrations or moisture content, where applicable. (DoD report formats only.)
MDL	- Method Detection Limit: This value represents the level to which target analyte concentrations are reported as estimated values, when those target analyte concentrations are quantified below the reporting limit (RL). The MDL includes any adjustments from dilutions, concentrations or moisture content, where applicable.
MS	- Matrix Spike Sample: A sample prepared by adding a known mass of target analyte to a specified amount of matrix sample for which an independent estimate of target analyte concentration is available. For Method 332.0, the spike recovery is calculated using the native concentration, including estimated values.
MSD	- Matrix Spike Sample Duplicate: Refer to MS.
NA	- Not Applicable.
NC	- Not Calculated: Term is utilized when one or more of the results utilized in the calculation are non-detect at the parameter's reporting unit.
NDPA/DPA	- N-Nitrosodiphenylamine/Diphenylamine.
NI	- Not Ignitable.
NP	- Non-Plastic: Term is utilized for the analysis of Atterberg Limits in soil.
RL	- Reporting Limit: The value at which an instrument can accurately measure an analyte at a specific concentration. The RL includes any adjustments from dilutions, concentrations or moisture content, where applicable.
RPD	- Relative Percent Difference: The results from matrix and/or matrix spike duplicates are primarily designed to assess the precision of analytical results in a given matrix and are expressed as relative percent difference (RPD). Values which are less than five times the reporting limit for any individual parameter are evaluated by utilizing the absolute difference between the values; although the RPD value will be provided in the report.
SRM	- Standard Reference Material: A reference sample of a known or certified value that is of the same or similar matrix as the associated field samples.
STLP	- Semi-dynamic Tank Leaching Procedure per EPA Method 1315.
TEF	- Toxic Equivalency Factors: The values assigned to each dioxin and furan to evaluate their toxicity relative to 2,3,7,8-TCDD.
TEQ	- Toxic Equivalent: The measure of a sample's toxicity derived by multiplying each dioxin and furan by its corresponding TEF and then summing the resulting values.
TIC	- Tentatively Identified Compound: A compound that has been identified to be present and is not part of the target compound list (TCL) for the method and/or program. All TICs are qualitatively identified and reported as estimated concentrations.

### Footnotes

*Report Format: DU Report with 'J' Qualifiers*

**Project Name:** MILDRED STRANG  
**Project Number:** Not Specified

**Lab Number:** L1903979  
**Report Date:** 05/06/19

- 1 - The reference for this analyte should be considered modified since this analyte is absent from the target analyte list of the original method.

### Terms

**Analytical Method:** Both the document from which the method originates and the analytical reference method. (Example: EPA 8260B is shown as 1.8260B.) The codes for the reference method documents are provided in the References section of the Addendum.

**Final pH:** As it pertains to Sample Receipt & Container Information section of the report, Final pH reflects pH of container determined after adjustment at the laboratory, if applicable. If no adjustment required, value reflects Initial pH.

**Frozen Date/Time:** With respect to Volatile Organics in soil, Frozen Date/Time reflects the date/time at which associated Reagent Water-preserved vials were initially frozen. Note: If frozen date/time is beyond 48 hours from sample collection, value will be reflected in 'bold'.

**Initial pH:** As it pertains to Sample Receipt & Container Information section of the report, Initial pH reflects pH of container determined upon receipt, if applicable.

**PFAS Total:** With respect to PFAS analyses, the 'PFAS, Total (5)' result is defined as the summation of results for: PFHpA, PFHxS, PFOA, PFNA and PFOS. If a 'Total' result is requested, the results of its individual components will also be reported.

**Total:** With respect to Organic analyses, a 'Total' result is defined as the summation of results for individual isomers or Aroclors. If a 'Total' result is requested, the results of its individual components will also be reported. This is applicable to 'Total' results for methods 8260, 8081 and 8082.

### Data Qualifiers

- A** - Spectra identified as "Aldol Condensation Product".
- B** - The analyte was detected above the reporting limit in the associated method blank. Flag only applies to associated field samples that have detectable concentrations of the analyte at less than ten times (10x) the concentration found in the blank. For MCP-related projects, flag only applies to associated field samples that have detectable concentrations of the analyte at less than ten times (10x) the concentration found in the blank. For DOD-related projects, flag only applies to associated field samples that have detectable concentrations of the analyte at less than ten times (10x) the concentration found in the blank AND the analyte was detected above one-half the reporting limit (or above the reporting limit for common lab contaminants) in the associated method blank. For NJ-Air-related projects, flag only applies to associated field samples that have detectable concentrations of the analyte above the reporting limit. For NJ-related projects (excluding Air), flag only applies to associated field samples that have detectable concentrations of the analyte, which was detected above the reporting limit in the associated method blank or above five times the reporting limit for common lab contaminants (Phthalates, Acetone, Methylene Chloride, 2-Butanone).
- C** - Co-elution: The target analyte co-elutes with a known lab standard (i.e. surrogate, internal standards, etc.) for co-extracted analyses.
- D** - Concentration of analyte was quantified from diluted analysis. Flag only applies to field samples that have detectable concentrations of the analyte.
- E** - Concentration of analyte exceeds the range of the calibration curve and/or linear range of the instrument.
- G** - The concentration may be biased high due to matrix interferences (i.e. co-elution) with non-target compound(s). The result should be considered estimated.
- H** - The analysis of pH was performed beyond the regulatory-required holding time of 15 minutes from the time of sample collection.
- I** - The lower value for the two columns has been reported due to obvious interference.
- J** - Estimated value. The Target analyte concentration is below the quantitation limit (RL), but above the Method Detection Limit (MDL) or Estimated Detection Limit (EDL) for SPME-related analyses. This represents an estimated concentration for Tentatively Identified Compounds (TICs).
- M** - Reporting Limit (RL) exceeds the MCP CAM Reporting Limit for this analyte.
- ND** - Not detected at the method detection limit (MDL) for the sample, or estimated detection limit (EDL) for SPME-related analyses.
- NJ** - Presumptive evidence of compound. This represents an estimated concentration for Tentatively Identified Compounds (TICs), where the identification is based on a mass spectral library search.
- P** - The RPD between the results for the two columns exceeds the method-specified criteria.
- Q** - The quality control sample exceeds the associated acceptance criteria. For DOD-related projects, LCS and/or Continuing Calibration Standard exceedences are also qualified on all associated sample results. Note: This flag is not applicable for matrix spike recoveries when the sample concentration is greater than 4x the spike added or for batch duplicate RPD when the sample concentrations are less than 5x the RL. (Metals only.)
- R** - Analytical results are from sample re-analysis.
- RE** - Analytical results are from sample re-extraction.
- S** - Analytical results are from modified screening analysis.

Report Format: DU Report with 'J' Qualifiers



**Project Name:** MILDRED STRANG**Lab Number:** L1903979**Project Number:** Not Specified**Report Date:** 05/06/19

## REFERENCES

- 1 Test Methods for Evaluating Solid Waste: Physical/Chemical Methods. EPA SW-846. Third Edition. Updates I - IV, 2007.
- 121 Standard Methods for the Examination of Water and Wastewater. APHA-AWWA-WEF. Standard Methods Online.

## LIMITATION OF LIABILITIES

Alpha Analytical performs services with reasonable care and diligence normal to the analytical testing laboratory industry. In the event of an error, the sole and exclusive responsibility of Alpha Analytical shall be to re-perform the work at it's own expense. In no event shall Alpha Analytical be held liable for any incidental, consequential or special damages, including but not limited to, damages in any way connected with the use of, interpretation of, information or analysis provided by Alpha Analytical.

We strongly urge our clients to comply with EPA protocol regarding sample volume, preservation, cooling, containers, sampling procedures, holding time and splitting of samples in the field.



**Alpha Analytical, Inc.**Facility: **Company-wide**Department: **Quality Assurance**Title: **Certificate/Approval Program Summary**ID No.: **17873**

Revision 12

Published Date: 10/9/2018 4:58:19 PM

Page 1 of 1

**Certification Information**

The following analytes are not included in our Primary NELAP Scope of Accreditation:

**Westborough Facility****EPA 624/624.1:** m/p-xylene, o-xylene**EPA 8260C:** NPW: 1,2,4,5-Tetramethylbenzene; 4-Ethyltoluene, Azobenzene; SCM: Iodomethane (methyl iodide), Methyl methacrylate, 1,2,4,5-Tetramethylbenzene; 4-Ethyltoluene.**EPA 8270D:** NPW: Dimethylnaphthalene, 1,4-Diphenylhydrazine; SCM: Dimethylnaphthalene, 1,4-Diphenylhydrazine.**EPA 6860:** SCM: Perchlorate**SM4500:** NPW: Amenable Cyanide; SCM: Total Phosphorus, TKN, NO<sub>2</sub>, NO<sub>3</sub>.**Mansfield Facility****SM 2540D:** TSS**EPA 8082A:** NPW: PCB: 1, 5, 31, 87, 101, 110, 141, 151, 153, 180, 183, 187.**EPA TO-15:** Halothane, 2,4,4-Trimethyl-2-pentene, 2,4,4-Trimethyl-1-pentene, Thiophene, 2-Methylthiophene, 3-Methylthiophene, 2-Ethylthiophene, 1,2,3-Trimethylbenzene, Indan, Indene, 1,2,4,5-Tetramethylbenzene, Benzothiophene, 1-Methylnaphthalene.**Biological Tissue Matrix:** EPA 3050B

The following analytes are included in our Massachusetts DEP Scope of Accreditation

**Westborough Facility:****Drinking Water****EPA 300.0:** Chloride, Nitrate-N, Fluoride, Sulfate; **EPA 353.2:** Nitrate-N, Nitrite-N; **SM4500NO3-F:** Nitrate-N, Nitrite-N; **SM4500F-C, SM4500CN-CE,****EPA 180.1, SM2130B, SM4500CI-D, SM2320B, SM2540C, SM4500H-B****EPA 332:** Perchlorate; **EPA 524.2:** THMs and VOCs; **EPA 504.1:** EDB, DBCP.**Microbiology:** **SM9215B; SM9223-P/A, SM9223B-Colilert-QT, SM9222D.****Non-Potable Water****SM4500H,B, EPA 120.1, SM2510B, SM2540C, SM2320B, SM4500CL-E, SM4500F-BC, SM4500NH3-BH:** Ammonia-N and Kjeldahl-N, **EPA 350.1:** Ammonia-N, **LACHAT 10-107-06-1-B:** Ammonia-N, **EPA 351.1, SM4500NO3-F, EPA 353.2:** Nitrate-N, **SM4500P-E, SM4500P-B, E, SM4500SO4-E, SM5220D, EPA 410.4, SM5210B, SM5310C, SM4500CL-D, EPA 1664, EPA 420.1, SM4500-CN-CE, SM2540D, EPA 300:** Chloride, Sulfate, Nitrate.**EPA 624.1:** Volatile Halocarbons & Aromatics,**EPA 608.3:** Chlordane, Toxaphene, Aldrin, alpha-BHC, beta-BHC, gamma-BHC, delta-BHC, Dieldrin, DDD, DDE, DDT, Endosulfan I, Endosulfan II, Endosulfan sulfate, Endrin, Endrin Aldehyde, Heptachlor, Heptachlor Epoxide, PCBs**EPA 625.1:** SVOC (Acid/Base/Neutral Extractables), **EPA 600/4-81-045:** PCB-Oil.**Microbiology:** **SM9223B-Colilert-QT; Enterolert-QT, SM9221E, EPA 1600, EPA 1603.****Mansfield Facility:****Drinking Water****EPA 200.7:** Al, Ba, Cd, Cr, Cu, Fe, Mn, Ni, Na, Ag, Ca, Zn. **EPA 200.8:** Al, Sb, As, Ba, Be, Cd, Cr, Cu, Pb, Mn, Ni, Se, Ag, TL, Zn. **EPA 245.1 Hg. EPA 522.****Non-Potable Water****EPA 200.7:** Al, Sb, As, Be, Cd, Ca, Cr, Co, Cu, Fe, Pb, Mg, Mn, Mo, Ni, K, Se, Ag, Na, Sr, TL, Ti, V, Zn.**EPA 200.8:** Al, Sb, As, Be, Cd, Cr, Cu, Fe, Pb, Mn, Ni, K, Se, Ag, Na, TL, Zn.**EPA 245.1 Hg.****SM2340B**

For a complete listing of analytes and methods, please contact your Alpha Project Manager.

1/31/19

L1903979

Please print clearly, legibly and completely. Samples can not be logged in and turnaround time clock will not start until any ambiguities are resolved. BY EXECUTING THIS COC, THE CLIENT HAS READ AND AGREES TO BE BOUND BY ALPHA'S TERMS & CONDITIONS. (See reverse side.)





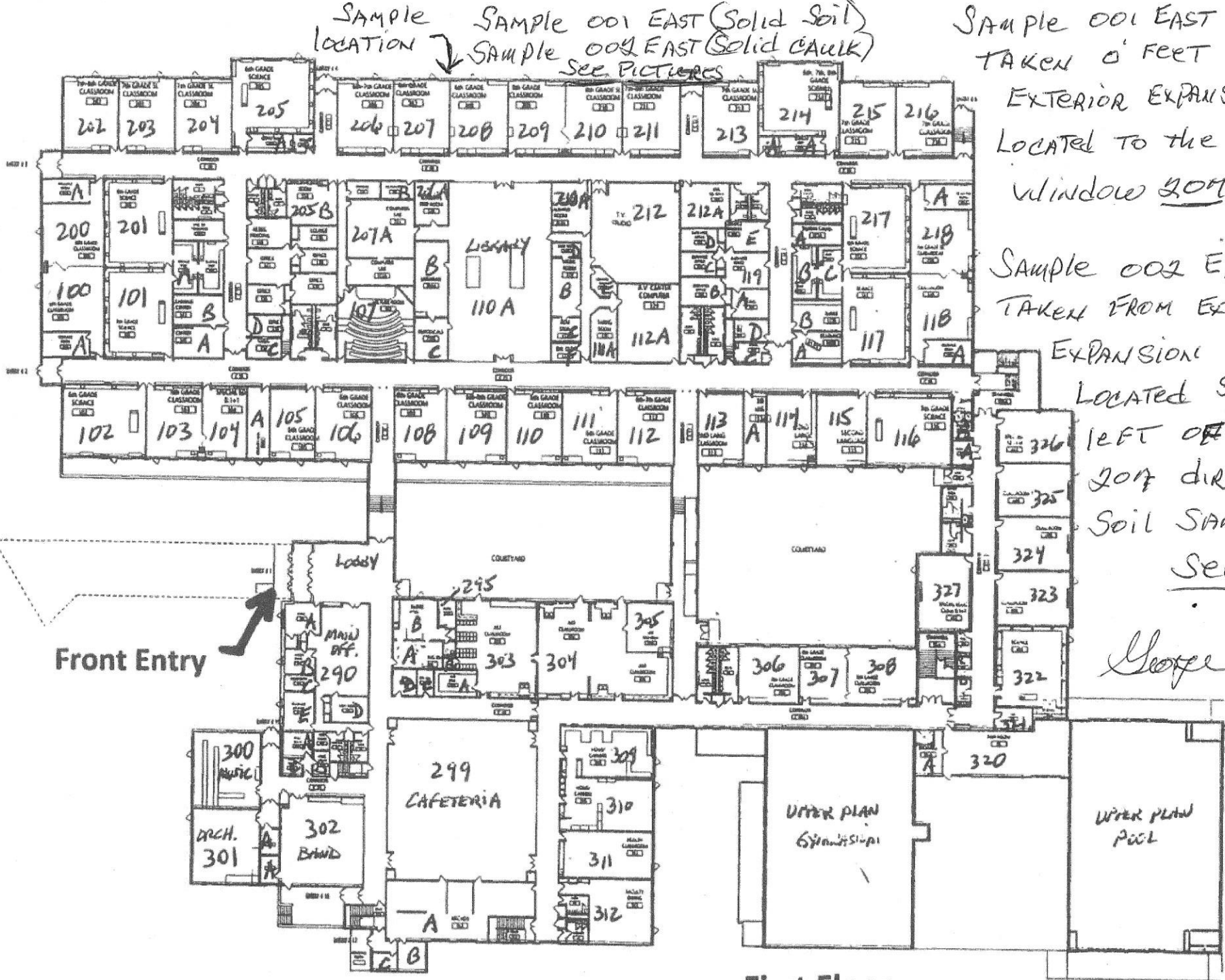

# Mildred E. Strang MS

01 Crompond Road, Yorktown Heights

First Floor













207